

# Mode Control Motor

## Replacement

1. Remove the dashboard lower cover (see [section 20](#)).
2. Disconnect the mode control motor connector.
3. Remove the mounting screws and mode control motor.

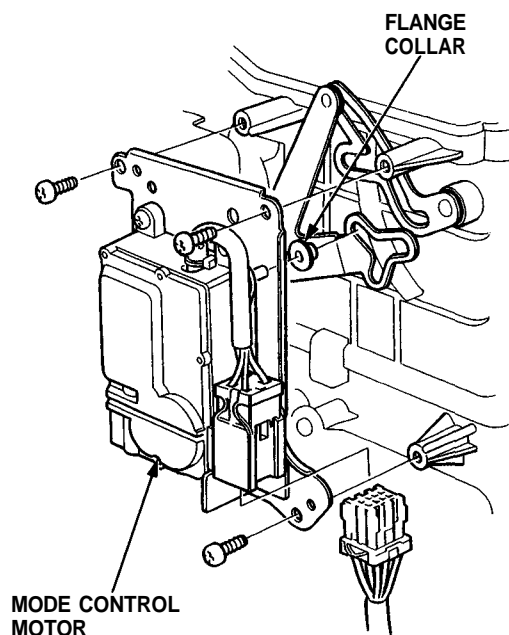

4. Install the mode control motor in the reverse order of removal. After installation, make sure the mode control motor operates smoothly.

## Test

1. Connect battery power to the No. 1 terminal of the mode control motor, and connect ground to the No. 2 terminal; the mode control motor should run, and stop at VENT.

If it doesn't, reverse the connections; the mode control motor should run, and stop at DBF.

NOTE: If the mode control motor does not run, remove it, and check the mode control linkage and doors for smooth movement. If the mode control linkage and doors move smoothly, replace the mode control motor.

2. Measure resistance between the No. 3 terminal and No. 5 terminal, it should be approx. 6 k $\Omega$
3. Measure resistance between the No. 5 terminal and No. 6 terminal, it should be approx. 1.2k $\Omega$  at VENT and approx. 4.8 k $\Omega$  at DEF.

